

Roller Blind 5-71

CHAIN OPERATED ROLLER BLIND BACK ROLLING WITH POCKET M

Description

- Die cast end brackets with plastic covers
 - Covers of brackets in grey, black or white to match colour of valance
- U-shaped extruded pocket with accessible closed bottom
 - In natural anodised, or powder coated black or white finish
- Pre-assembled blind installed on hidden aluminium clip-in brackets
- Leveling function to limit skewing
 - Optional no leveler
- Patented clutch for safe operation in grey, black or white
- Universal clutch for left and right hand operation
- High tensile stainless steel endless ball chain
 - Optional plastic ball chain in grey, black or white
- Spring-loaded end plug and removable closing profile for easy maintenance
- Aluminium extruded tubes
- Aluminium extruded bottom rail, natural anodised, black or white
 - Optional oval shaped bottom rail
- Back rolling
- UV stable parts
- High quality fabric according to technical specifications

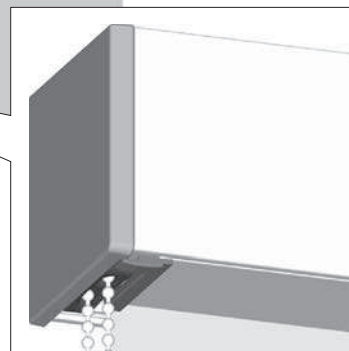
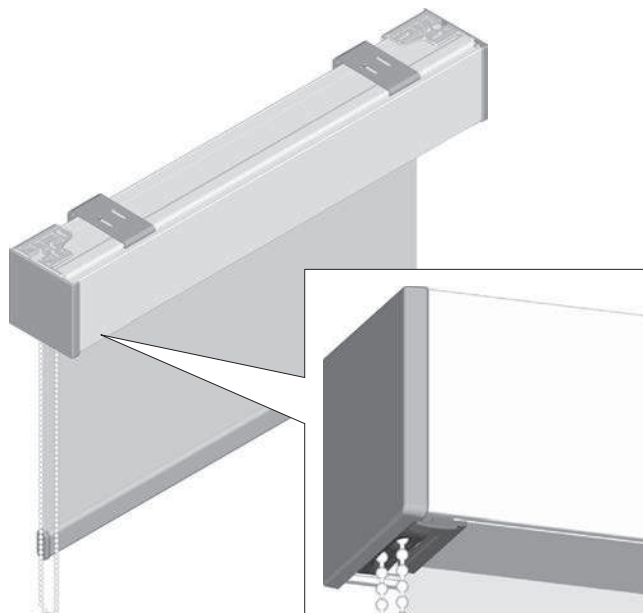

LIGHT GAPS (mm)		
Operation side	20	a
Bearing side	24	b

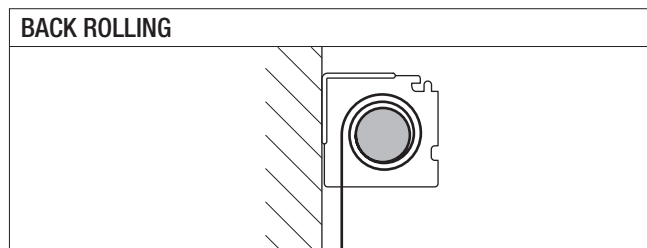

SIZE LIMITATIONS*

Min. width	300 mm
Max. width	3600 mm
Min. height	500 mm
Max. height	4000 mm
Max. surface	single blind; 10 m ² coupled blinds; 13 m ²

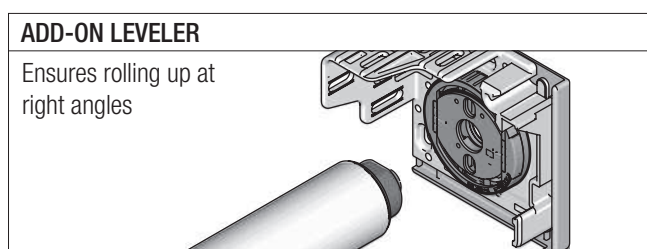

MAXIMUM LOAD (KG)*

Type	Tube 31	Tube 37	Tube 50
Gear 1:1 x 1	2.5	-	-
Gear 1:1 x 2	4.7	4.0	3.0
Gear 1.75:1	5.8	5.0	3.7

Maximum load = bottom rail + (optional) additional weight + fabric

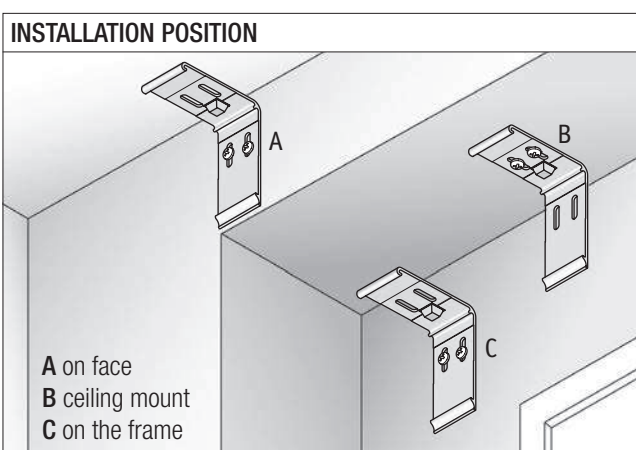
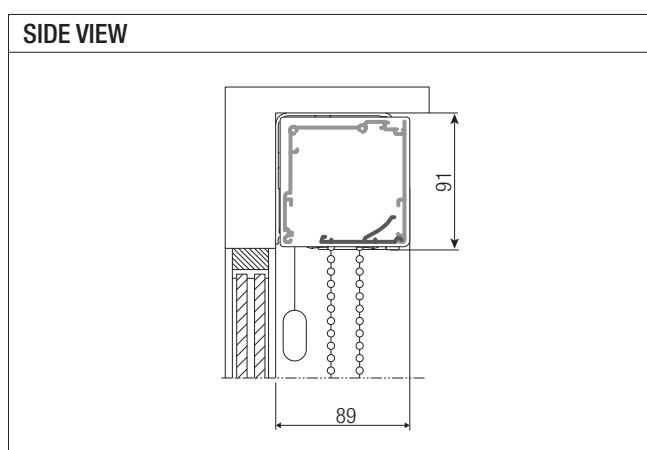

OPTIONS Roller Blind 5-71

The technical terms on this page are clarified in the glossary in the back.

LEVELER

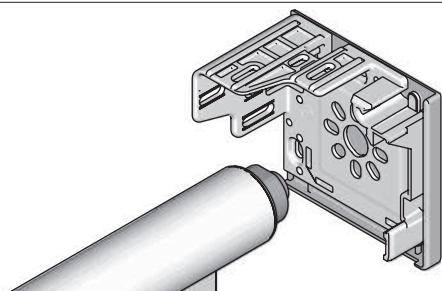

No leveler

LIGHT GAPS (mm)

Operation side	20	a
Bearing side		
Add-on leveler (std)	24	b
No leveler	15	b

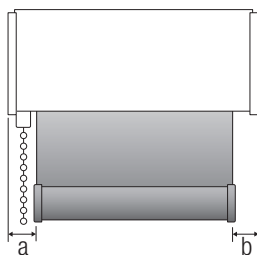

COUPLING (see page 174)

Straight coupling with aligner

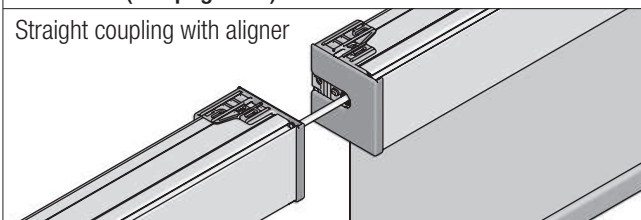

OVAL BOTTOM RAIL

Not applicable with side guiding profiles

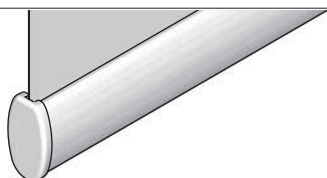

SIDE GUIDING; PROFILES

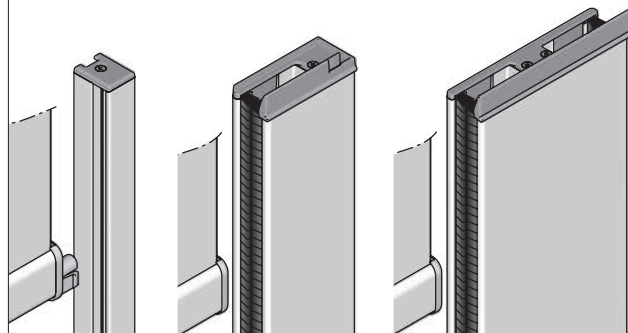

SCG 20

SCG 64

SCG 64 coupled

LIGHT GAPS (mm); SCG 20

Operation side	5	a
Bearing side		
Add-on leveler (std)	5	b
No leveler	5	b

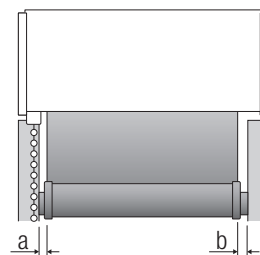

SIDE GUIDING; SPRING TENSIONED CABLE

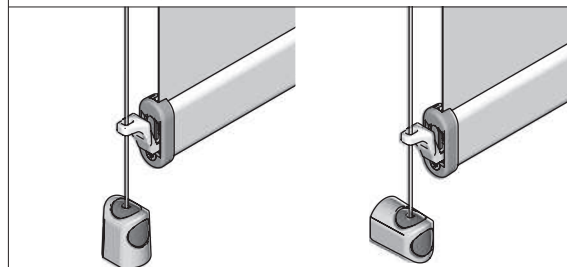

In recess

On face

LIGHT GAPS (mm)

Operation side	20	a
Bearing side		
Add-on leveler	24	b
No leveler	20	b

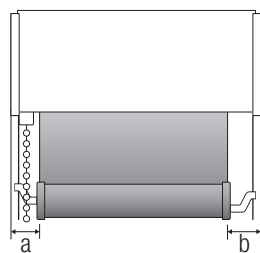

*Size limitations and maximum load depend on operation type and are further calculated on the basis of a fabric with; weight = 345 gr/m², thickness = 0.44 mm. Maximum deflection of tube 31 = 3 mm, tube 37 = 4 mm, tube 50 = 5 mm.