

Roller Blind 5-26

MOTOR OPERATED ROLLER BLIND INSTALLED ON MOUNTING PROFILE M

Description

- Pearl chrome finished die cast design brackets fixed on mounting profile
 - Optional powder coated steel brackets in grey, black or white
- Easy installation on mounting clips allowing a more flexible positioning
- Integrated leveling function to limit skewing
 - Optional add-on leveler or no leveler
- Range of motors available depending on requirements
 - Current: 24V or 230V
 - Force from 3.5 kg to 15 kg
 - Noise standard or quiet
 - Wired control (recommended) or remote
- Spring-loaded end plug for easy maintenance
- Aluminium extruded tubes
- Aluminium extruded bottom rail, natural anodised, black or white
 - Optional oval shaped bottom rail
- Back or front rolling
- UV stable parts
- High quality fabric according to technical specifications

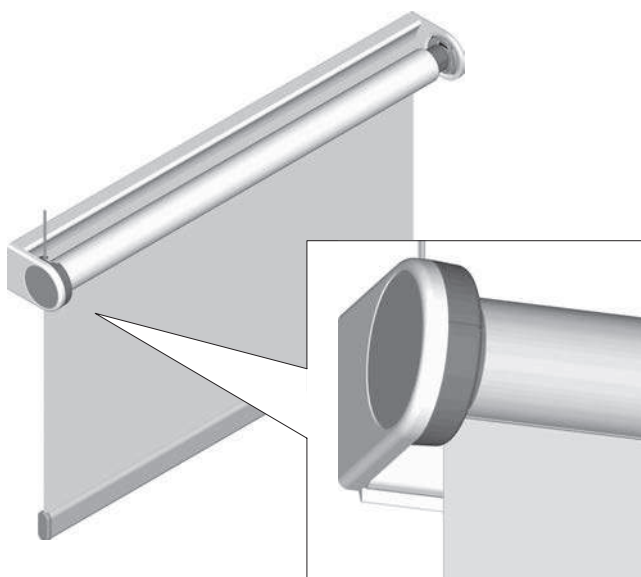

| LIGHT GAPS (mm) | | | width | | height |
|-----------------|----|---|-------|---|--------|
| Drive side | | | a | b | |
| Motor LT 28 | 22 | a | | | |
| Motor LS 40 | 23 | a | | | |
| Motor M 40 | 23 | a | | | |
| Bearing side | | | 20 | b | |

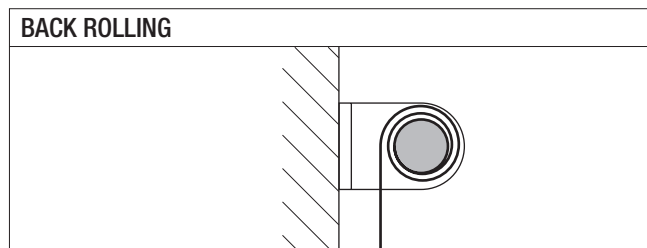

SIZE LIMITATIONS*

| | |
|--------------|---|
| Min. width | 380 - 645 mm (depending on motor size) |
| Max. width | 3600 mm |
| Min. height | 500 mm |
| Max. height | 4000 mm |
| Max. surface | single blind; 12 m ² coupled blinds; 34 m ² |

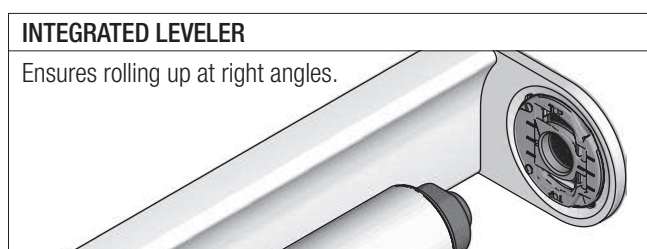

MAXIMUM LOAD (KG)*

| Type | U | Tube 31 | Tube 37 | Tube 50 |
|-------------|------|---------|---------|---------|
| Motor LT 28 | 24V | 4.0 | 3.5 | - |
| Motor LS 40 | 230V | - | - | 15.0 |
| Motor M 40 | 230V | - | - | 15.0 |

Maximum load = bottom rail + (optional) additional weight + fabric

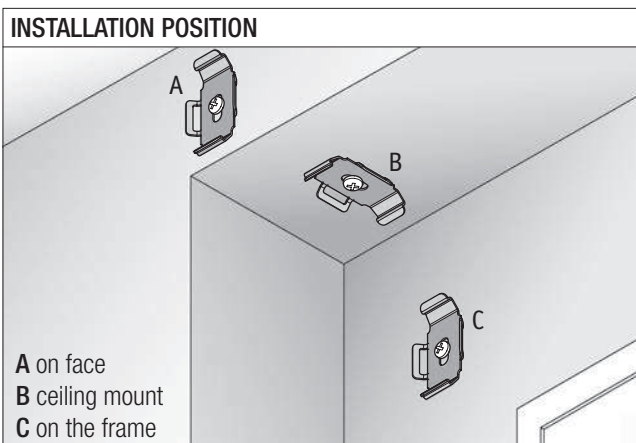
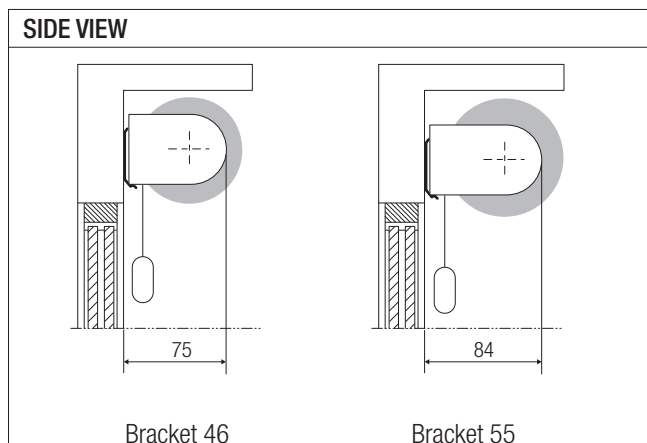

OPTIONS Roller Blind 5-26

The technical terms on this page are clarified in the glossary in the back.

LEVELER

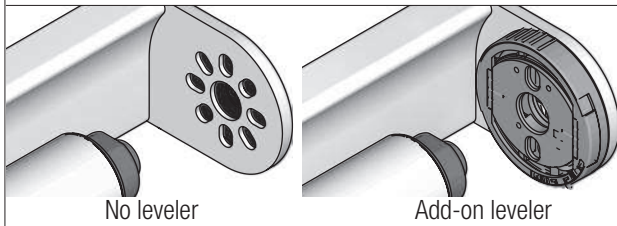

LIGHT GAPS (mm)

Drive side

| | | |
|-------------|----|---|
| Motor LT 28 | 22 | a |
| Motor LS 40 | 23 | a |
| Motor M 40 | 23 | a |

Bearing side

| | | |
|--------------------------|----|---|
| Integrated leveler (std) | 20 | b |
| No leveler | 18 | b |
| Add-on leveler | 27 | b |

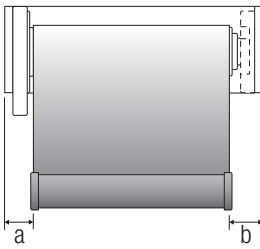

FRONT ROLLING

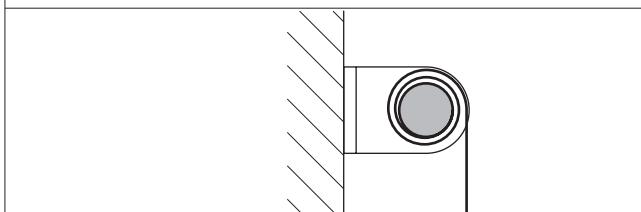

COUPLING (see page 174)

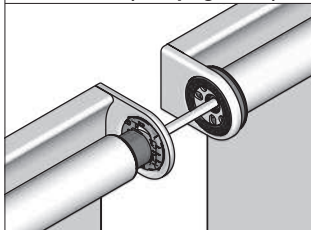

Straight coupling with aligner

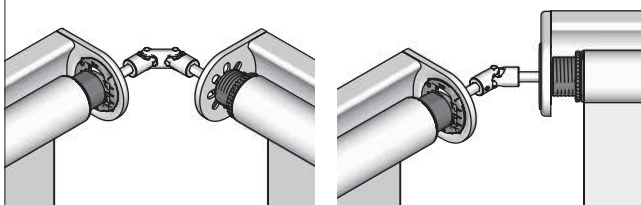

90° coupling

45° coupling

OVAL BOTTOM RAIL

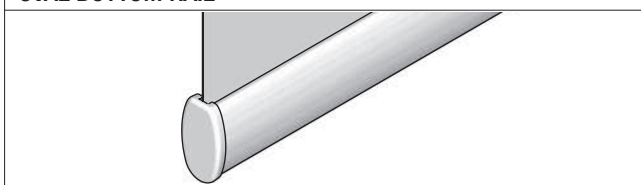

BRACKETS

Steel bracket with plastic cover

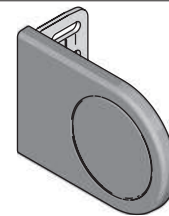

SIDE GUIDING; SPRING TENSIONED CABLE

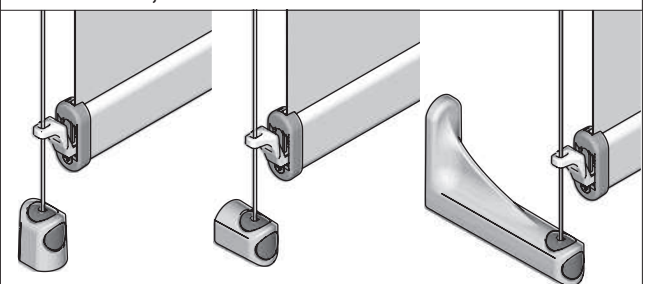

In recess

On face

On face, front rolling

LIGHT GAPS (mm)

Drive side

| | | |
|-------------|----|---|
| Motor LT 28 | 22 | a |
| Motor LS 40 | 23 | a |
| Motor M 40 | 23 | a |

Bearing side

| | | |
|--------------------------|----|---|
| Integrated leveler (std) | 20 | b |
| No leveler | 20 | b |
| Add-on leveler | 27 | b |

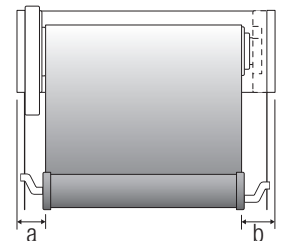

*Size limitations and maximum load depend on operation type and are further calculated on the basis of a fabric with; weight = 345 gr/m², thickness = 0.44 mm. Maximum deflection of tube 31 = 3 mm, tube 37 = 4 mm, tube 50 = 5 mm.