

Roller Blind 5-211

CHAIN OPERATED ROLLER BLIND INSTALLED ON END BRACKETS L

Description

- Heavy-duty powder coated steel brackets in white, grey or black
- Integrated leveling function to limit skewing
 - Optional no leveler
- Patented clutch with mounting plate for easy and secure installation in white, grey or black
- Universal 3:1 clutch, with integrated autostop, for left and right hand operation
- 1:1 Clutch with patented Counter Balance System (CBS) for large and heavy or coupled blinds
- High tensile stainless steel chain (ø 6.4 mm)
 - Optional plastic ball chain (ø 6.4 mm) in white, grey or black
- Spring loaded end plug with locking ring for safe use and easy maintenance
- Aluminium extruded tubes
- Aluminium extruded bottomrail in white, natural anodized or black
 - Optional oval shaped bottom rail
- Back or front rolling
- UV stable parts
- High quality fabric according to technical specifications

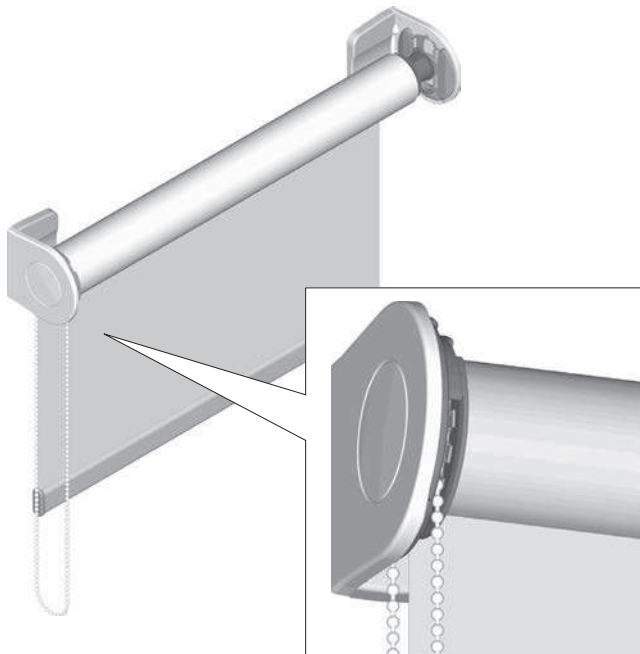

LIGHT GAPS (mm)		
Operation side	25	a
Bearing side	23	b

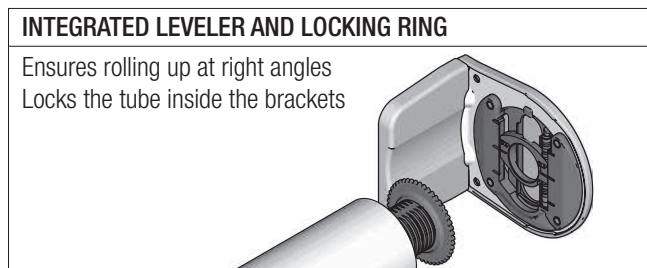
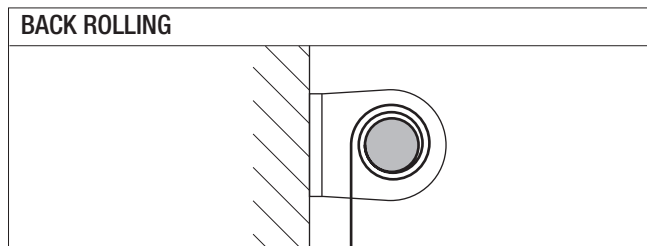

SIZE LIMITATIONS*

Min. width	220 mm (depending on CBS size)
Max. width	4000 mm
Min. height	500 mm
Max. height	6000 mm
Max. surface	single blind; 16 m ² coupled blinds; 48 m ²

MAXIMUM LOAD (KG)*

Type	Tube 50	Tube 62
Gear 1:1, Counter Balance System	20	20
Gear 3:1	6.0	4.8

Maximum load = bottom rail + (optional) additional weight + fabric

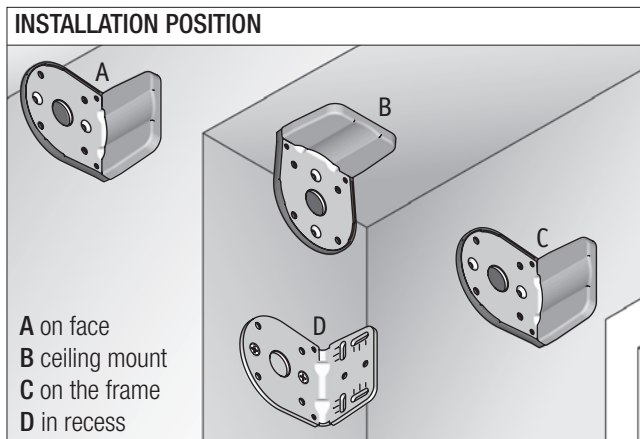
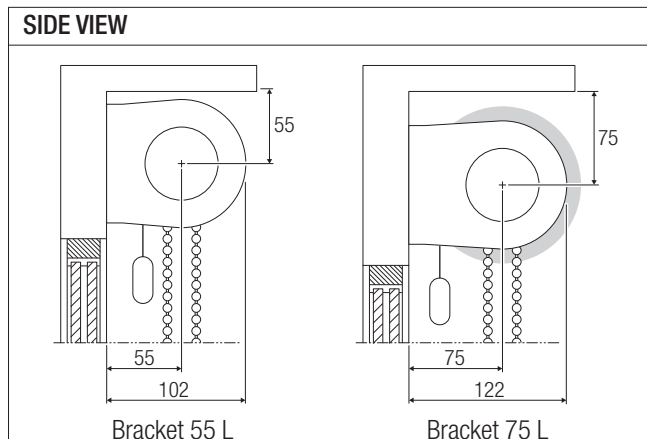

OPTIONS Roller Blind 5-211

The technical terms on this page are clarified in the glossary in the back.

LEVELER

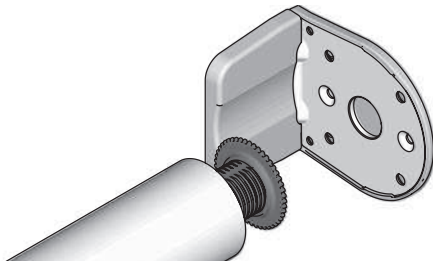

No leveler

LIGHT GAPS (mm)

Operation side	25	a
Bearing side		
Integrated leveler (std)	23	b
No leveler	19	b

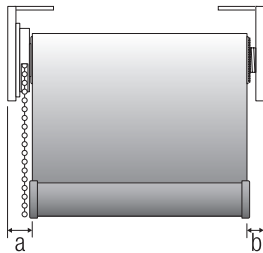

FRONT ROLLING

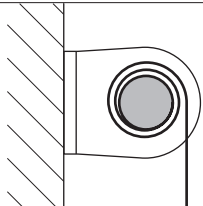

AUTOSTOP

Optional; 3:1 gear without autostop.

COUPLING (see page 174)

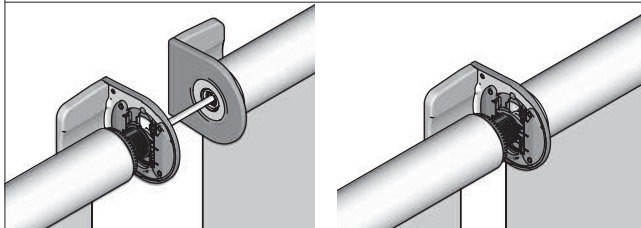

Straight coupling with aligner

Straight coupling

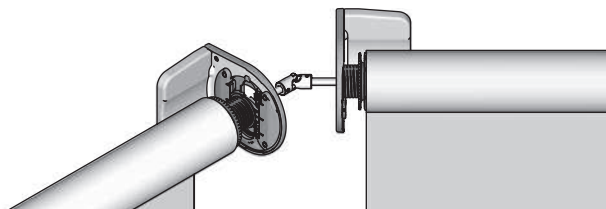

45° coupling

SIDE GUIDING; SPRING TENSIONED CABLE

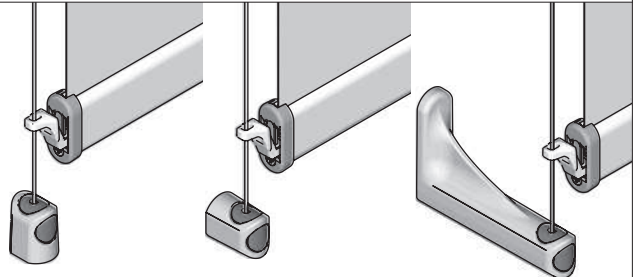

In recess

On face

On face, front rolling

LIGHT GAPS (mm)

Operation side	25	a
Bearing side		
Integrated leveler (std)	23	b
No leveler	22	b

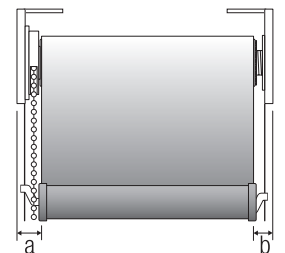

OVAL BOTTOM RAIL

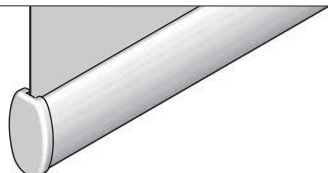

*Size limitations and maximum load depend on operation type and are further calculated on the basis of a fabric with; weight = 345 gr/m², thickness = 0.44 mm. Maximum deflection of tube 50 = 5 mm and tube 62 = 6 mm.